

Ring Bolts -Pad Eyes

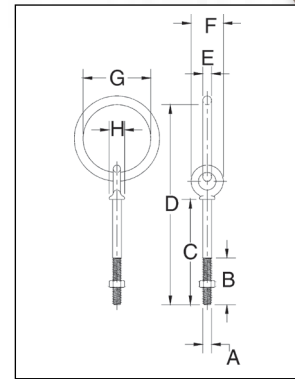

G-257
Shoulder Nut
Ring Bolts

- Forged Steel - Quenched and Tempered.
- Hot Dip galvanized.
- All Bolts Hot Dip galvanized after threading.
- Diameter of ring stock is same as shank diameter.



G-257 Shoulder Nut Ring Bolts

Ring Bolt Size (in.)	G-257 Stock No.	Working Load Limit (lbs.)*	Weight Per 100 (lbs.)	Dimensions (in.)							
				A	B	C	D	E	F	G	H
3/8 x 4-1/2	1046335	1200	56.60	.38	2.50	4.50	7.66	.38	1.38	2.00	.66
1/2 X 6	1046371	2200	100.00	.50	3.00	6.00	10.00	.50	1.75	2.50	.91

*Ultimate Load is 5 times the Working Load Limit.



S-264
Pad Eye

- Forged Steel — Quenched and Tempered.
- Forged from 1035 Carbon Steel.
- Excellent welding qualities.
- Widely used on farm machinery, trucks, steel hulled marine vessels and material handling equipment.
- Reference American Welding Society specifications for proper welding procedures.

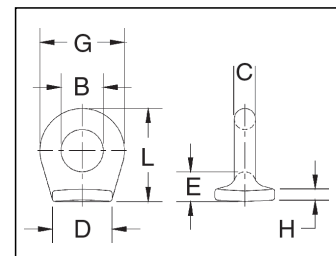

S-264 Pad Eyes

Size No.*	S-264 Stock No.	Weight Per 100 (lbs.)	Dimensions (in.)							
			B	C	D	E	G	H	L	
* 0	1090722	2.80	.25	.19	.63	.31	.63	.09	.75	
* 1	1090740	6.50	.38	.25	.88	.41	.88	.13	1.03	
* 1-1/2	1090768	10.40	.63	.25	1.00	.44	1.13	.16	1.31	
2	1090786	21.10	.75	.38	1.06	.50	1.50	.19	1.63	
4	1090802	52.20	1.00	.56	1.44	.78	2.13	.22	2.34	
5	1090820	82.50	1.25	.69	1.75	.81	2.63	.25	2.75	

*Meets the requirements of Military Specification MS-51930A.

WESTECH RIGGING SUPPLY
Call Toll Free: 800-442-7475

Call Us or Visit Our Stores:
Monday - Friday, 8:00am - 5:30pm Pacific



Distributed By

Visit Us Online at: www.WestechRigging.com

4140 West 11th Avenue
Eugene, Oregon 97402

2439 McGilchrist St SE
Salem, Oregon 97302