

2

1

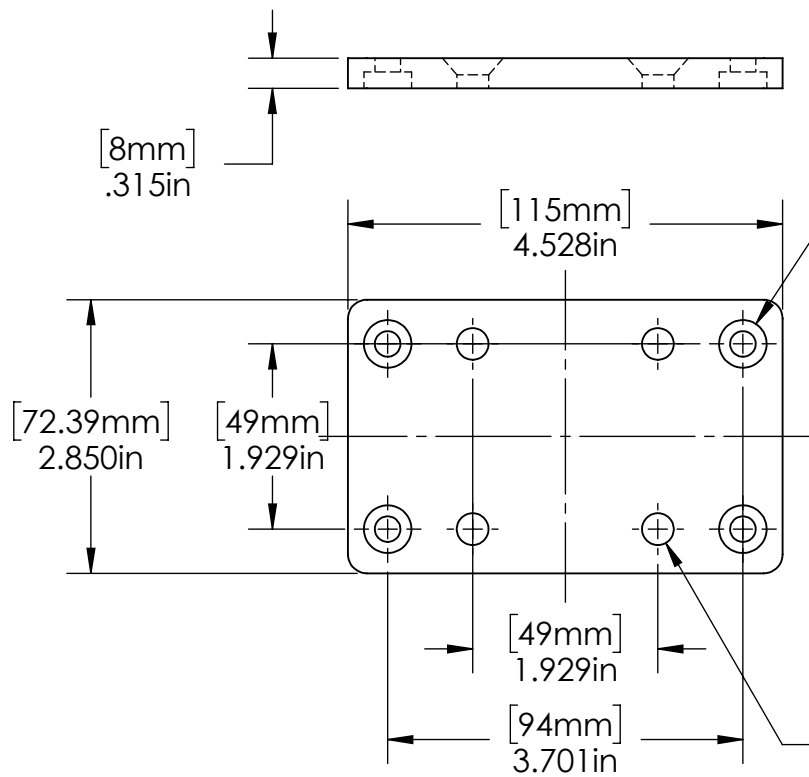

4X  $\phi$  .266in [6.76mm] THRU ALL  
 $\phi$  .496in [12.60mm]  $\nabla$  .170in [4.32mm]

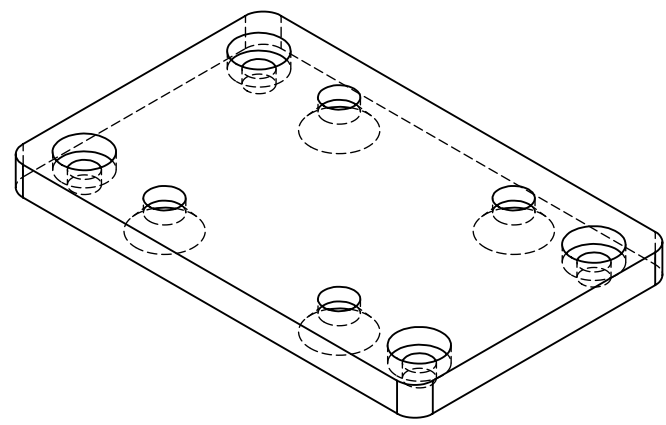

4X  $\phi$  .331in [8.41mm] THRU ALL  
 $\phi$  .635in [16.13mm] X 82°, FAR SIDE

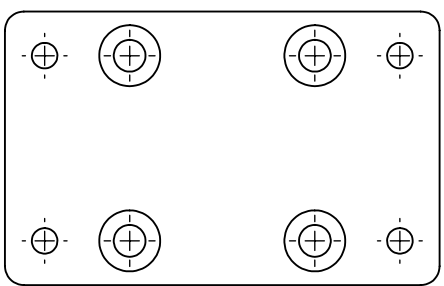

**NOTE:** ALL HOLES ARE CENTERED ON PART



PROPRIETARY AND CONFIDENTIAL

THE INFORMATION CONTAINED IN THIS DRAWING IS THE SOLE PROPERTY OF STAINLESS CABLE AND RAILING®. ANY REPRODUCTION IN PART OR AS A WHOLE WITHOUT THE WRITTEN PERMISSION OF STAINLESS CABLE AND RAILING® IS PROHIBITED.

NOTES: UNLESS OTHERWISE SPECIFIED		NAME	DATE	TITLE:	
1. DIMENSIONS SHOWN - INCHES [MM].	DIMENSIONS ARE IN INCHES [MM]	DRAWN	JC	Top Rail Plate 2"-4"	
2. MACHINED SURFACES TO BE 63uIN MAX.	ANGULAR: MACH ± 0.1°	ENG APPR.			
4. PART TO BE FREE OF BURRS AND SHARP EDGES.	X.X ± 0.1 MM	MFG APPR.			
5. ALL MATERIAL TO BE CLEAN, DEGREASED AND FREE OF ALL IMPURITIES.	X.XX ± 0.01 MM	COMMENTS:		SIZE	DWG. NO.
6. ANY CHANGE MUST BE AUTHORIZED BY AN SC&R ENGINEER.	X.XXX ± 0.005 MM	Powdercoating to meet or exceed AAMA2604 Salt Spray Resistance		<b>A</b>	03-017-01
	MATERIAL			SCALE: 1:2	WEIGHT:
	6082-T6 ALU			SHEET 1 OF 1	
	FINISH				
	Powdercoat				
	DO NOT SCALE DRAWING				

2

1