

Versatile™ 4C Mailbox, 4C15S-06

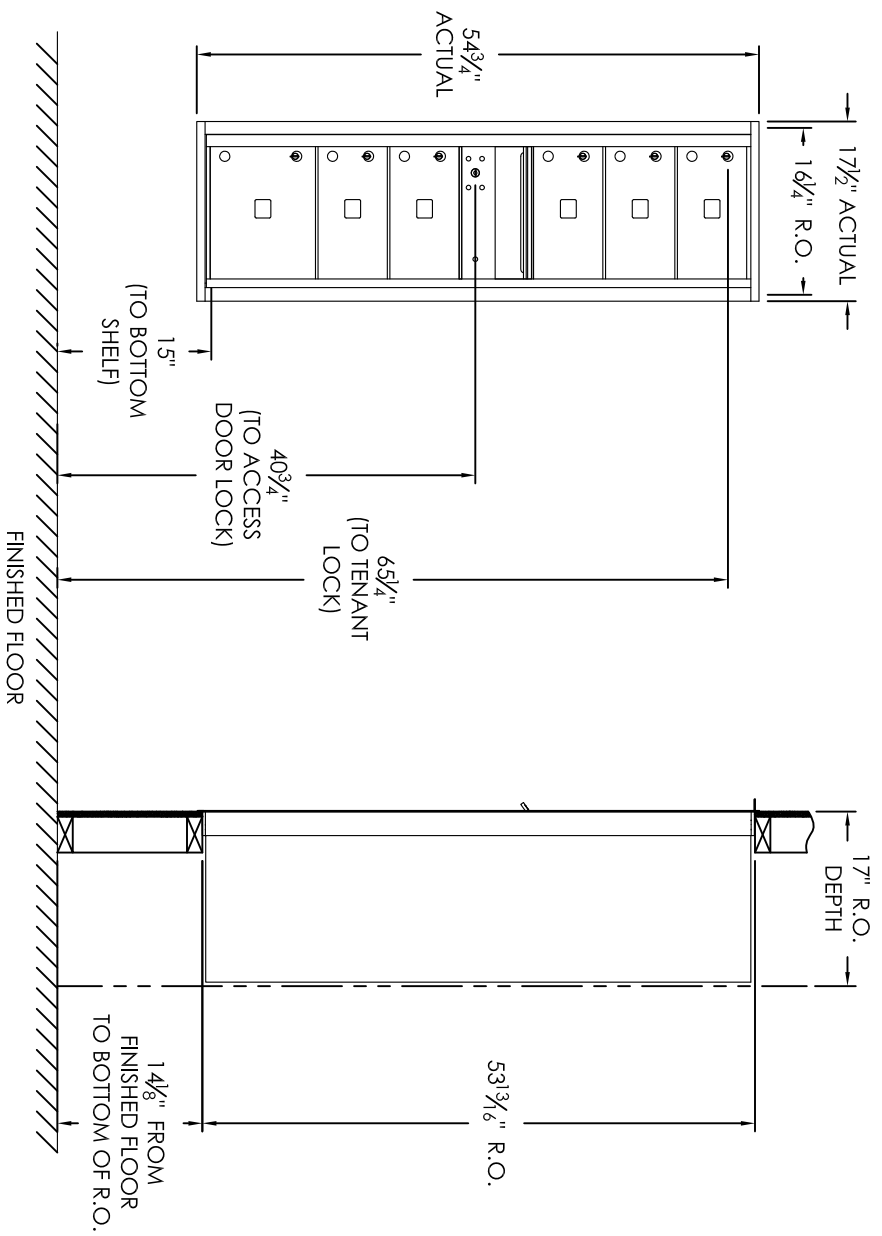

COMPARTMENT CHART

DESCRIPTION	COMPARTMENT	COMPARTMENT SIZE	QTY.
MAILBOX	MB2	6-1/2" H x 12" W x 15" D	5
MAILBOX	MB3	10" H x 12" W x 15" D	1
OUTGOING MAIL	OM2	6-1/2" H x 12" W x 15" D	1

PRODUCT SERIES: VERSATILE™ 4C FRONT LOAD MAILBOX

MODEL	4C15S-06	REV	D
-------	----------	-----	---

SCALE	NONE	LAST REV DATE	5/15/14
-------	------	---------------	---------

DRAWING NUMBER	4C15S-06CS	DRAWN BY	RS
----------------	------------	----------	----

Notes:

- This module does NOT meet USPS STD-4C installation specification requirements as shown below:
 - At least one customer compartment shall be positioned less than 48" above finished floor (AFF).
 - No parcel locker (interior bottom shelf) shall be positioned less than 15" AFF.
 - No patron (tenant) lock shall be positioned more than 67" AFF.
 - No customer compartment (interior bottom shelf) shall be positioned less than 28" AFF.
 - The USPS Arrow lock shall be positioned 36" - 48" AFF.
- This 4C mailbox is to be used for private applications.
- The rough opening width for multi-unit 4C installations = (the sum of all actual unit widths) - 1 1/8".