

Patent No. 7784430

IDEAL Vinyl Patio Pet Door

Installation Instructions

For Standard & Tall Vinyl Patio Pet Doors

Before You Get Started...

- It is important to read all instructions carefully and make sure you have all the parts listed below before beginning pet door installation.
- Your pet door may be installed on the right or left side depending on which way your sliding door opens.
- There are several lock styles for vinyl sliding doors. See page 6 to determine which lock you have.
- If you need help with any part of the installation, call one of our associates Toll Free at **(800) 378-4385** (M-F, 9 am to 4 pm, PST) and they will be happy to help you free of charge.

As with any home improvement project, if you do not have the tools or skills to properly install your pet door, we suggest using a professional handyman or licensed contractor.

Tools Required For Installation –



Parts List –

1. 2 Hangers* with 4 (#10 x 1-1/2") Screws and 6 Spacers* (POLY BAG #1)

*Parts color may be white

2. 2 Lock Catches* with 4 (#10 x 1") Self Drilling Screws and 4 Spacers* (POLY BAG #2)

*Parts color may be white

3. 1 Top "H" Section and 2 (#10 x 5/8") Self Drilling Screws (POLY BAG #3)

4. 1 Door Seal Extension and 8 (#10 x 1") Self Drilling Screws (POLY BAG #4)

5. 2 Door Seal Extrusions

6. 2 Draft•Seal™ Flat Pieces*

*Parts color may be white

7. 1 Lock Button Override* (see page 6) (POLY BAG #2)

*Parts color may be white

Installing Your White Vinyl Patio Pet Door

Step #1-Installing the Pet Panel Door Hangers



Remove existing Lock Catch plate as it may interfere with your new Vinyl Patio Pet Door Panel. (see Picture #1) If your catch plate is 1" wide or less, you can reinstall into the Vinyl Patio Pet Door.

Poly Bag #1 contains 2 Hangers and 4 Screws #10 x 1-1/2" long.

Locate position of hangers. (see Sketch A)

Mark 2 lines inside door frame, the lower at 5" and the upper at 84-1/2" (for Tall Door) or, 69" (for Standard Door) from bottom of track.

Place bottom edge of lower hanger on the 5" marked line and the upper hanger at 84-1/2" (for Tall Door) or, 69" (for Standard Door) marked line.

Mark location of hanger screw holes with pencil and drill 1/8" dia. hole approx. 1-1/2" deep.

Place hangers in track and install using #10 x 1-1/2" screws. (see Picture #2)

Important: Do Not Overtighten



Lift and locate Pet Panel in place. (see Picture #3)

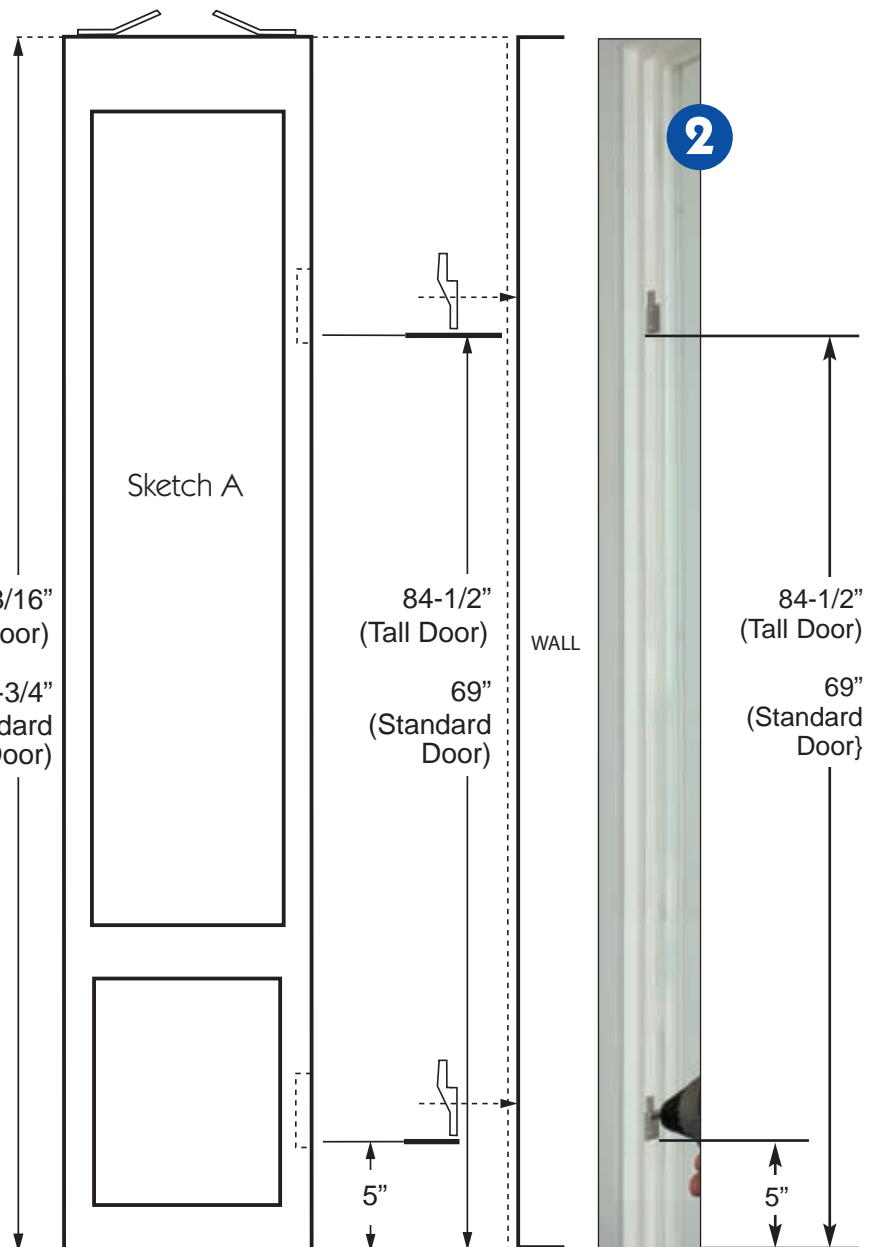

Continue to Page 3...

Installing Your White Vinyl Patio Pet Door (continued)

Step #2 – Measuring the “H” Section Gap (5/16”)

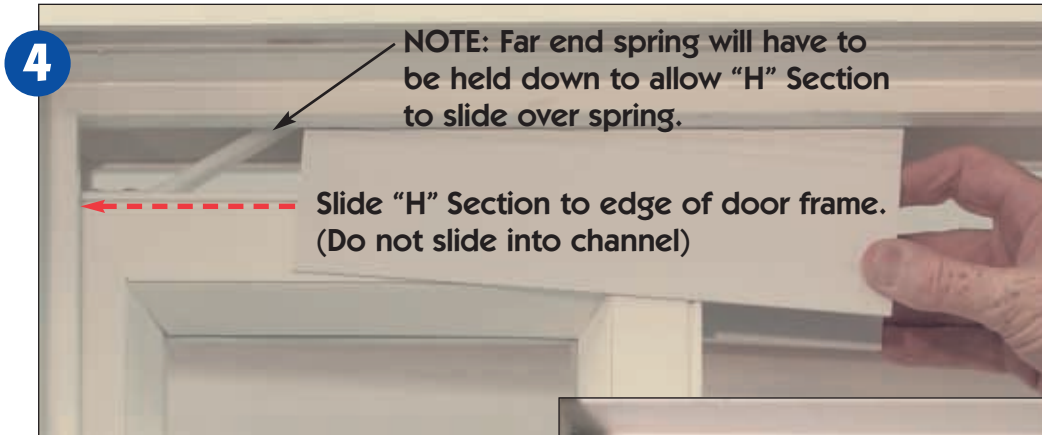

Insert top “H” section on top of pet door panel (see Picture #4) until it is flush to frame. (see Picture #5)



NOTE: “H” Section must be flush with outer frame.

Measure the distance from the edge of pet door panel to edge of “H” section. (see Picture #6)
This distance should be 5/16”.

If it is less than 5/16” you need to determine how many spacers will be needed to install between the hangers and the inside of the sliding patio door frame to correct the distance. (see Sketch B)



Sketch B

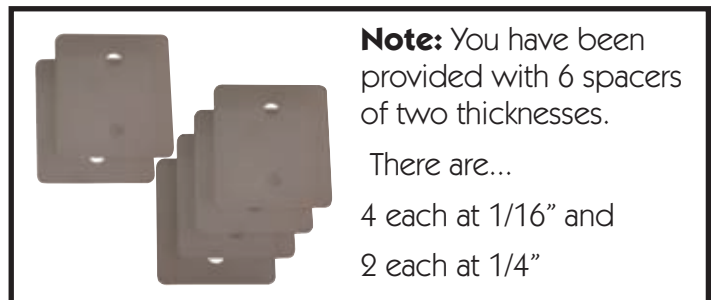
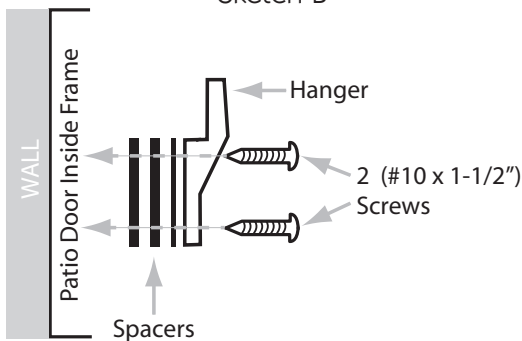

Continue to Page 4...

Continuing the Installation...

Step #3-Install the Top "H" Section

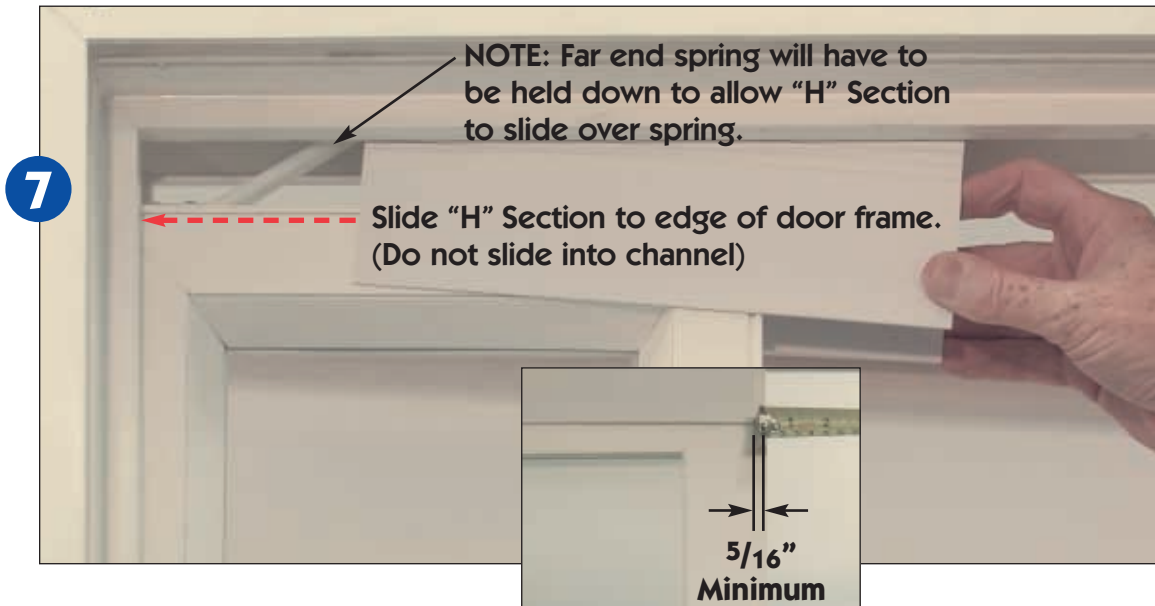

Slide Top "H" Section over top of springs until it is flush to frame, making sure that it is 5/16" minimum from the side of door to edge of "H" Section. (see Picture #7 and inset)

Step #4-Install Door Seal Extension

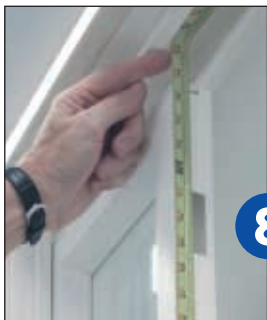

Your pet door includes one Door Seal Extension and two Door Seal Extrusions which mount on the side of the Vinyl Pet Door Panel.



To properly measure the Door Seal Extension for installation, measure length from the top outer edge track (see Picture #8) to the bottom outer edge of the door frame. (see Picture #9)



Use this measurement to mark the length on the Door Seal Extension. (see Picture #10)



Using a hacksaw, cut Door Seal Extension to length. (see picture #11)

Place cut Door Seal Extension against door panel. Extension rests on outer edge of door frame, top and bottom.

Insert the 8 (#10 x 1") Self Drilling Screws into the 8 pre-drilled holes and tighten securely. (see Picture #12)

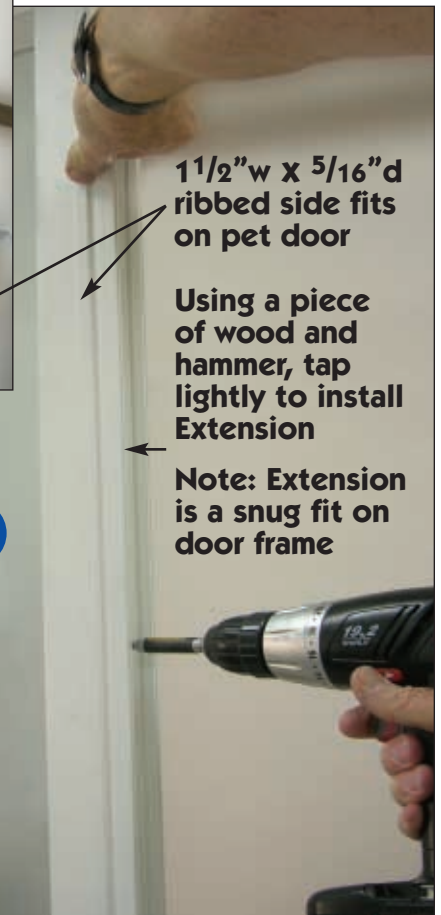

Continue to Page 5...

Continuing the Installation...

Step #5-Secure the Top “H” Section

Complete by installing 2 (#10 x 5/8”) Self Drilling Screws through the Top “H” Section into the Vinyl Pet Door Panel on the inside of door. (see Picture #13)



Continue to Page 6...

Continuing the Installation...

Step #6-Installing the Lock Catch

Our instructions will cover the majority of sliding door locks. If your door lock is not compatible with the enclosed lock components, you can use an alternate method of securing your door. Please call us Toll Free at **(800) 378-4385** for more information.

Adjustment Screw

NOTE: Most sliding doors have an adjustable locking mechanism (see Picture #14). To increase or decrease the locking strength of your door, turn Adjustment Screw in or out.

14



If your lock looks like this...

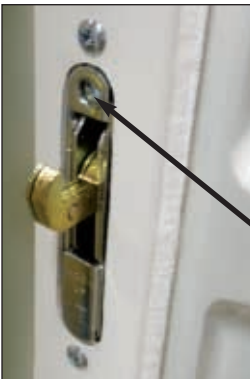

Single Hook-Style Door Lock

...then place One Lock Catch and Spacer like this.



Adjustment Screw

If your lock looks like this...



Double Hook-Style Door Lock

...then place Two Lock Catches and Spacers like this.



Adjustment Screws



If your lock looks like this...



Double Hook Reverse-Style Door Lock

...then place Two Lock Catches and Spacers like this.



Adjustment Screws



If your sliding door lock has a small button below the latch hook...



...you will need to install the Lock Button Override.

15

Peel paper off the two-sided tape. Position pin to depress the lock button and press firmly in place. (see Picture #15)

Continue to Page 7...

Continuing the Installation...

Step #7-Installing the Lock Catch (continued)

Place Lock Catch onto your existing door lock hook in the up (locked) position. (see Picture #16)

16



17

Partially close your sliding door so that you can mark the location of the top edge of Lock Catch inside your pet door frame. (see Picture #17)

WARNING: SCREWS PROVIDED ARE SELF-TAPPING, NO DRILLING REQUIRED. DO NOT USE DRILL BITS IN ANY PART OF INSTALLATION ON THIS PAGE.

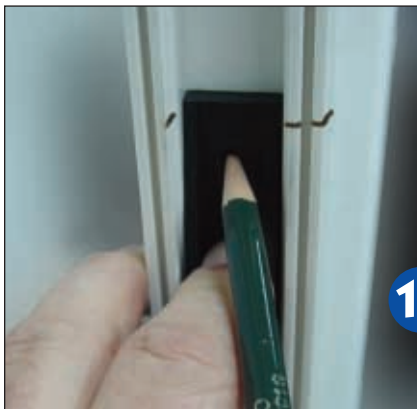

18

Open door, relocate Lock Catch to line up with pencil and mark holes (see Picture #18). Install Lock Catch, through vinyl into reinforced plate, using #10 x 1" Self Drilling Screws provided in Poly Bag #2. (see Picture #19) Use Spacer if needed. Lock Catch has slotted holes for adjustment if necessary.

19



If your sliding door has double hook-style lock, repeat steps for second hook.

Step #8-Install Door Seal Extrusions

20

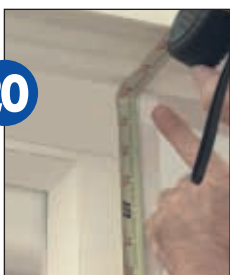

To properly measure the Door Seal Extrusions for installation, close your sliding glass door against the pet door and measure length from the top of slider to the bottom sill of the door frame. (see Picture #20)

Repeat this step for other side.

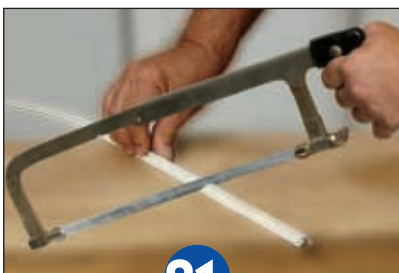

21

After measuring length, use a hacksaw to cut Door Seal Extrusions to length (see picture #21) then, working from the bottom up, press firmly and verify Seal Extrusions are snapped into grooves. (see Picture #22)

Repeat these steps for other side.

NOTE: In the event you are unable to close slider against the pet door, the Extrusions inside soft vinyl gaskets may be removed. (see Picture #23)

22

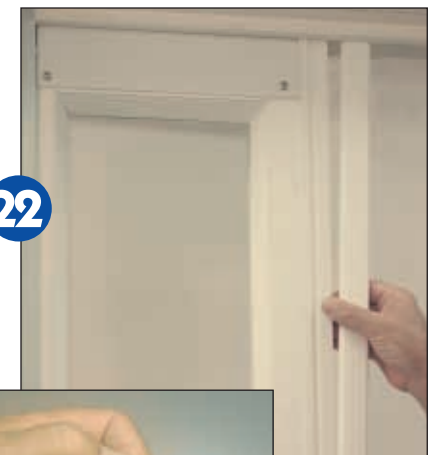

23



Continue to Page 8 to finish installation...

Finishing the Installation

Step #9-Attaching the Draft•Seal™ and Optional Sliding Door Adjustments

The Draft•Seal™ (combined in 2 pieces) attaches to the moving section of your sliding glass door. To install the Draft•Seal™, measure the vertical distance, or height of exposed glass between top and bottom frames of the sliding door and using this length, cut Draft•Seal™ to size with scissors.



First, clean the surface of frame with household glass cleaner, then starting at top, attach Draft•Seal™ by aligning edge so that it rubs lightly against glass. (see Picture #24) Pull paper off tape and gently press in place while working slowly down the Draft•Seal™.

Do not press too firmly in the event that repositioning is necessary. Be sure that vinyl rubs lightly against glass all the way down length of glass. Press Draft•Seal™ firmly in place along entire length when you are satisfied it is correctly placed.

We recommend caulking around entire pet panel, inside and outside, to insure the best possible weather seal

NOTE: If the sliding door portion of your vinyl patio door is not plumb with the Vinyl Pet Door Panel, you may need to adjust the bottom rollers on the sliding vinyl patio door. Please refer to the manufacturers adjustment instructions for your specific vinyl sliding patio door style.