

# Versatile™ 4C Mailbox, 4C08S-03

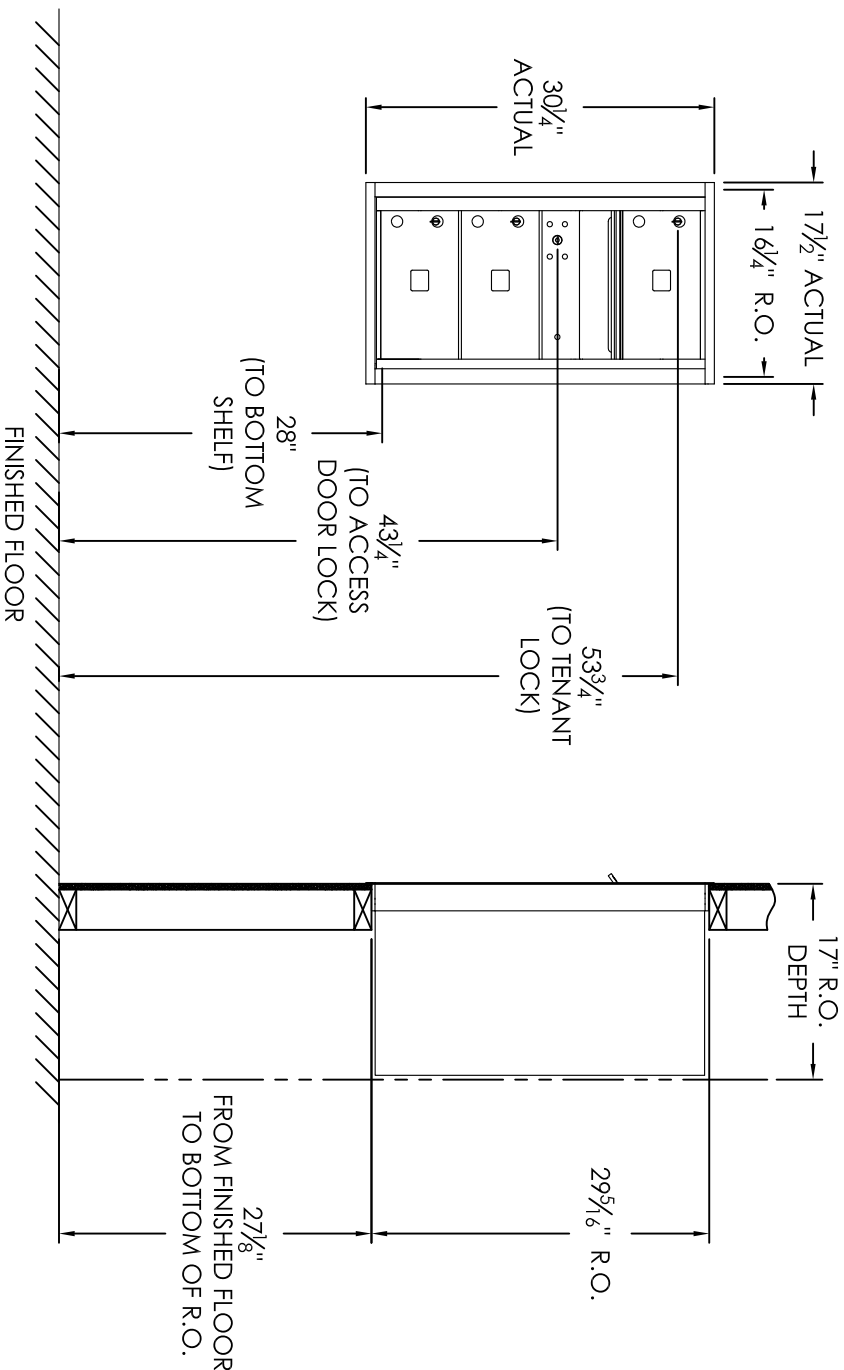

## COMPARTMENT CHART

DESCRIPTION	COMPARTMENT	COMPARTMENT SIZE	QTY.
MAILBOX	MB2	6-1/2" H X 12" W X 15" D	3
OUTGOING MAIL	OM2	6-1/2" H X 12" W X 15" D	1

PRODUCT SERIES: VERSATILE™ 4C FRONT LOAD MAILBOX

### Notes:

- This module meets the USPS STD-4C requirements for installation defined below when the mailbox is installed per the dimensions provided on this drawing.
  - At least one customer compartment shall be positioned less than 48" above finished floor (AFF).
  - No parcel locker (interior bottom shelf) shall be positioned less than 15" AFF.
  - No patron (tenant) lock shall be positioned more than 67" AFF.
  - No customer compartment (interior bottom shelf) shall be positioned less than 28" AFF.
  - The USPS Arrow lock shall be positioned 36"-48" AFF.
- This 4C mailbox can also be used for private applications.
- The rough opening width for multi-unit 4C installations = (the sum of all actual unit widths) - 1 1/8".

**AF FLORENCE**  
manufacturing company

MODEL: 4C08S-03 REV: B

SCALE: NONE LAST REV DATE

DRAWING NUMBER: 4C08S-03CS DRAWN BY