

Versatile™ 4C Mailbox, 4C04S-1P

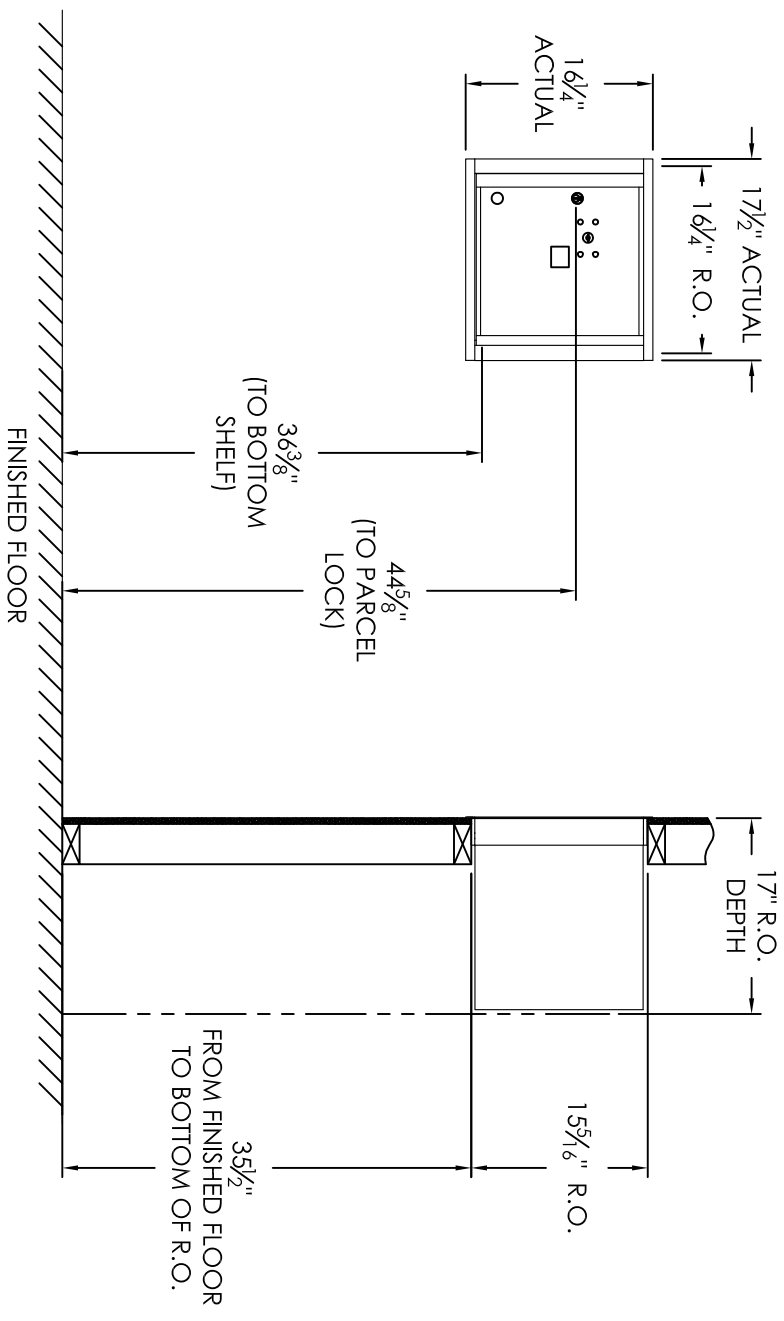

COMPARTMENT CHART

| DESCRIPTION | COMPARTMENT | COMPARTMENT SIZE | QTY. |
|-------------|-------------|---------------------------|------|
| PARCEL | PL4 | 13-1/2" H x 12" W x 15" D | 1 |

PRODUCT SERIES: VERSATILE™ 4C FRONT LOAD MAILBOX

- Notes:
- This module meets the USPS STD-4C requirements for installation defined below when the mailbox is installed per the dimensions provided on this drawing.
 - At least one customer compartment shall be positioned less than 48" above finished floor (AFF).
 - No parcel locker (interior bottom shelf) shall be positioned less than 15" AFF.
 - No patron (tenant) lock shall be positioned more than 67" AFF.
 - No customer compartment (interior bottom shelf) shall be positioned less than 28" AFF.
 - The USPS Arrow lock shall be positioned 36"-48" AFF.
 - This 4C mailbox can also be used for private applications.
 - The rough opening width for multi-unit 4C installations = (the sum of all actual unit widths) - 1 1/8".



BudgetMailboxes
Best Brands. Best Prices. .com

WebLife Stores LLC
PO Box 20338, Panama City Beach, FL 32417
www.budgetmailboxes.com • (866) 707-0008

| MODEL | REV |
|----------------|---------------|
| 4C04S-1P | B |
| SCALE | LAST REV DATE |
| NONE | |
| DRAWING NUMBER | DRAWN BY |
| 4C04S-1PCS | |