

ADJUSTABLE TABS

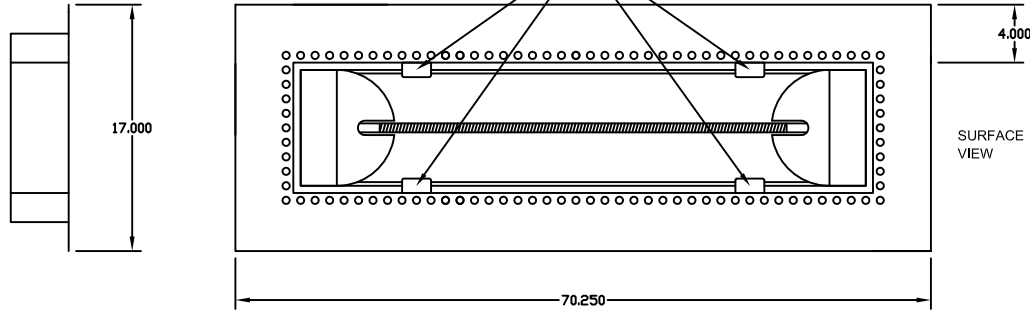

INSTALLATION TYPES

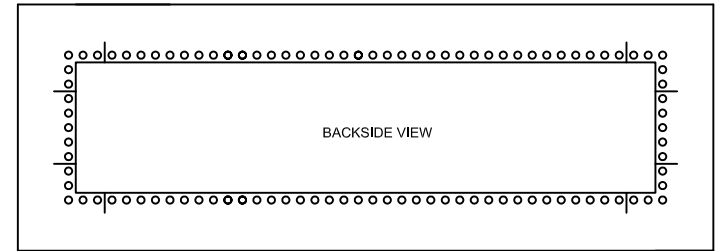
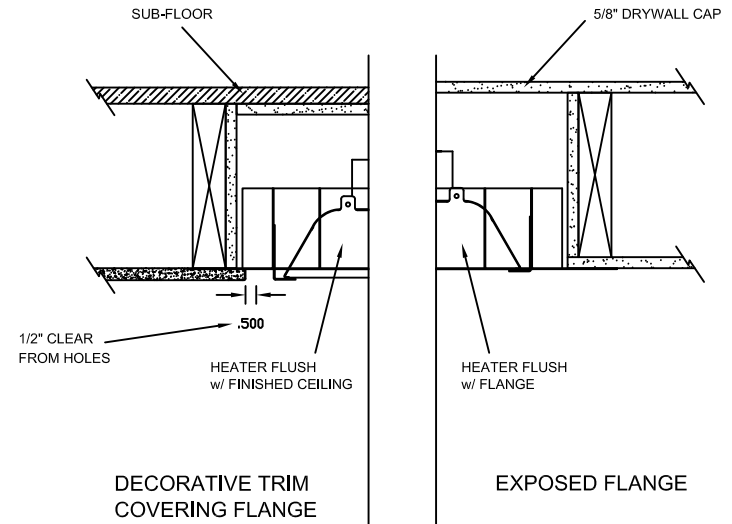

- NOTES:
- Heater suspends (Gravity) by resting on adjustable tabs in flush mount fixture.
 - Mounting holes on Surface Flange to be determined and drilled by Contractor/Installer.
 - Supplied with Hi-Temp Fixture Whip and 2 Hi-Temp Wire Nuts
 - Coil excess flex into heater cavity
 - Use Licensed Electrician ONLY

INFRA TECH[™]
www.infratech-usa.com

344 W. 157th Street
Gardena, California 90248
Phone: (310) 354-1250
Fax: (310) 523-3674

ITEM #:	X-18-2305	MATERIAL:	304 S.S. #4 FINISH
---------	-----------	-----------	--------------------

DESCRIPTION: W-61 FLUSH MOUNT PLASTER FRAME (FOR USE WITH 61 1/4" W-SERIES HEATERS)

NOTES: SUPPLIED w/ ELECTRICAL FIXTURE WHIP

DATE:	Aug. 19, 2010	SCALE:	N/A	DRAWN BY:	MD
-------	---------------	--------	-----	-----------	----