

Tri-Tronics Owner's Guide

Sport Series

Remote Trainers

Models covered:

Sport 50 Sport 60 Sport 65 BPR
Multi•Sport 2 Multi•Sport 3

T R I - T R O N I C S

CONGRATULATIONS!

You have purchased one of the finest dog training products available.

Tri-Tronics Remote Trainers have been specially designed to meet the needs of all dog trainers, from top winning professionals to people training their very first dog.

Tri-Tronics takes great pride in the design, manufacture, service and safety of all our products. Any time you have a question, need customer support, or have a problem don't hesitate to contact us.

Our Customer Service Department can be reached at **1-800-456-4343**. Or visit us on-line at **www.tritronics.com**.

Thank you for choosing Tri-Tronics. Making it easy for dogs to learn is our passion and commitment to you, our valued customer.

Product Specifications

Product specifications may change without notice or obligation since Tri-Tronics is committed to a policy of continuous improvement.

Certain Tri-Tronics products are covered by one or more of these U.S. patent numbers: 4794402, 4802482, 5054428, 5099797, 5193484, 5471954, D298872, 4947795, 4202293, 4335682, D410206, 6178439, D445706, D446144 and patents pending.

Owner's Registration Reply Card

Please take a moment to complete and return the Owner's Registration Reply Card. When you do, you'll be "on file" at Tri-Tronics. This will help ensure timely, no-questions-asked warranty work should you need it. You may also register on our web site at **www.tritronics.com** by clicking on "Online Product Registration."

T R I T R O N I C S

Table Of Contents

TABLE OF CONTENTS

QUICK GUIDE	1
MODEL GUIDE.....	2
INSTALLING THE COLLAR STRAP	7
INSTALLING THE TRANSMITTER ANTENNA	8
TURNING THE REMOTE TRAINER ON AND OFF.....	9
FITTING THE COLLAR ON THE DOG	11
SETTING THE INTENSITY.....	12
USING THE STIMULATION BUTTONS	13
USING THE TONE (Sport 60 only)	15
USING THE BEEPER (Sport 65 BPR only)	15
RANGE	16
RADIO SIGNAL ISSUES	16
FCC COMPLIANCE	16
BATTERY CARE	17
Transmitter Battery	17
Collar Batteries.....	18
Storing the Remote Trainer	20
CARE AND CLEANING.....	21
SERVICE AND WARRANTY	22
PRODUCT SAFETY.....	23
TROUBLESHOOTING GUIDE	25

T R I - T R O N I C S

Notes

Notes:

QUICK GUIDE

Before You Start...

1. Install the collar strap(s) (page 7).
2. Install the transmitter antenna (page 8).
3. Charge collar battery for 14 hours (page 18).
The transmitter is shipped with one replaceable 9-volt battery already installed.

Using the Remote Trainer

1. **Turn the collar on:** Set the intensity dial on 0 (zero). Hold the transmitter within 10 feet of the collar and hold a button down for about 5 seconds. The collar light double-blinks to confirm it is turned on. (A rapid blink means that collar batteries are low.) Once the collar is turned on, move the intensity dial to a setting other than 0 (zero) for training. To turn the collar off, repeat the turn-on process.
2. **Fit the collar on the dog:** Fasten the collar strap midway between dog's ears and shoulders, and buckle snugly. The collar light should face towards the dog's nose. Do not leave a collar on a dog continuously. See page 11.
3. **Select an intensity level for training:** Level 1/2 is the lowest; level 5 is the highest. Release the transmitter button when changing levels during training. Intensity selection tips are in your training manual and video.
4. **Transmitter buttons:**
Sport 50: Black button – momentary stimulation.
Red button – continuous stimulation.
Sport 60: Same as Sport 50 with addition of green button for audible tone.
Sport 65 BPR: Same as Sport 50 with addition of orange button to turn the Beeper on and off.
Multi•Sport 2: Green button – continuous stimulation from collar with green strap. Orange button – continuous stimulation from collar with orange strap.
Multi•Sport 3: Same as Multi•Sport 2 with addition of yellow button for continuous stimulation from collar with yellow strap.

T R I - T R O N I C S
Model Guide

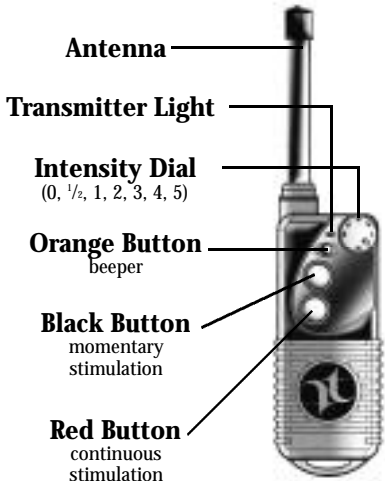

SPORT 65 BPR

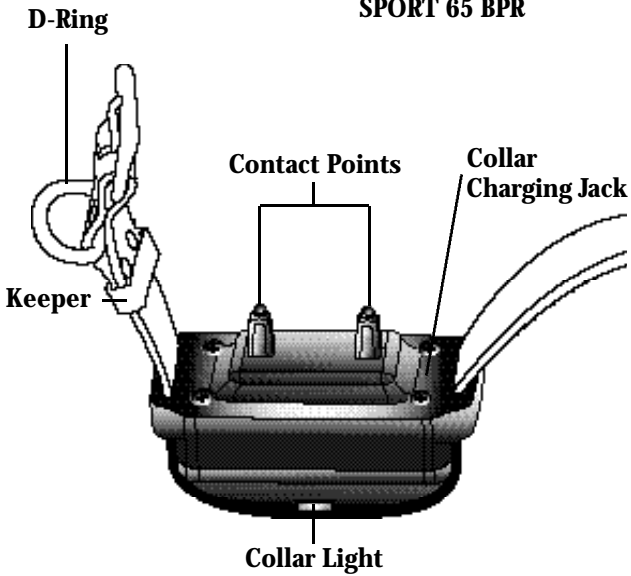

T R I - T R O N I C S

Model Guide

Feature Model	Dogs trained and range	Stimulation choices
Sport 50	Training and control of one dog – up to 1/2 mile range	6 levels of momentary 6 levels of continuous
Sport 60	Training and control of one dog – up to 1/2 mile range Additional feature: audible tone	6 levels of momentary 6 levels of continuous Audible tone (no stimulation)
Sport 65 BPR	Training and control of one dog – up to 1/2 mile range Additional feature: multi-function Beeper*	6 levels of momentary 6 levels of continuous
Multi•Sport 2	Basic training and control of two dogs – up to 1/2 mile range	6 levels of continuous
Multi•Sport 3	Basic training and control of three dogs – up to 1/2 mile range	6 levels of continuous

*Beeper operation is covered in the Tri-Tronics Beeper Owner's Guide

Transmitter buttons	Intensity levels	Collars operated and strap colors
Black button – momentary stimulation Red button – continuous stimulation	$1/2 - 5$	One collar – black strap
Black button – momentary stimulation Red button – continuous stimulation Green button – audible tone	$1/2 - 5$	One collar – black strap
Black button – momentary stimulation Red button – continuous stimulation Orange button – Beeper on/off	$1/2 - 5$	One collar – orange strap
Green button – green collar continuous stim. Orange button – orange collar continuous stim.	$1/2 - 5$	Two collars – green strap orange strap
Green button – green collar continuous stim. Orange button – orange collar continuous stim. Yellow button – yellow collar continuous stim.	$1/2 - 5$	Three collars – green strap orange strap yellow strap

Collar Light

Action	Collar Function
Double flash	Collar is turned on
Glows steadily *	Collar is receiving signal from transmitter
Single long flash (3.5 seconds)	Collar has just been turned off
Rapid flash **	Low batteries. Recharge the collar soon
Glows steadily while on charger	Collar is charging

* It will take 20 seconds after turn-on before the light will glow steadily or before the collar will stimulate.

** If the batteries are low at the time the collar is turned on, the low battery signal can be delayed by up to 20 seconds. Also note that in cold weather the low battery light may come on prematurely.

Transmitter Light

Action	Transmitter Function
Illuminates when a button is pressed	Transmitting
Flashes rapidly when a button is pressed.	Low battery. Unit will not operate. Replace the 9-volt battery.

INSTALLING THE COLLAR STRAP

Your Remote Trainer is shipped with the receiver separate from the collar strap. Install the strap as shown. On multi-dog units (the Multi•Sport 2 and Multi•Sport 3), be sure to install the correct color strap on each receiver. Use the strap that matches the colored dot on the receiver.



You can easily adjust the strap for different sized necks by sliding the receiver along the strap. If the strap is too long for your dog, you can cut off excess length. Leave enough length to go through the D-ring (see "Fitting the Collar on the Dog" page 11). Note that you will need extra strap length to go around the Beeper, so do not cut the collar strap of the Sport 65 BPR until after you have installed both the Beeper and the receiver on the strap.

You may also use any collar strap that fits the receiver.

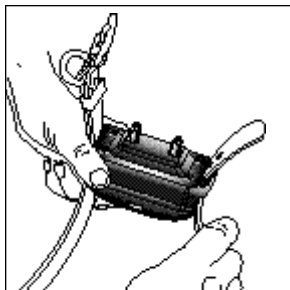
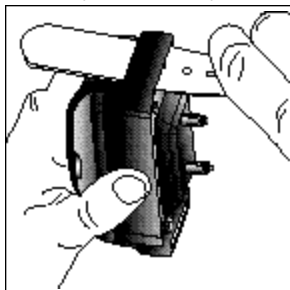

Slide the correct color strap through one side of the receiver, then through the other side. Snug the strap firmly against the surface of the receiver. Position the buckle where it is convenient for the size of your dog's neck.

Installing the Transmitter Antenna

INSTALLING THE TRANSMITTER ANTENNA

Screw the transmitter antenna into the top of the transmitter. Hold the antenna near the base and tighten firmly by hand. Check the antenna regularly for tightness.



Hold the antenna near its base and tighten by hand.

Turning the Remote Trainer On and Off

TURNING THE REMOTE TRAINER ON AND OFF

The Remote Trainer consists of a hand-held transmitter and a radio receiver on the dog's collar. The collar must be turned on before it can receive signals from the transmitter.

To turn the Remote Trainer collar on, set the transmitter intensity dial to the number 0 (zero). Hold the transmitter close to the collar (any distance between 2 and 10 feet). Hold down any transmitter button as you watch the light on the front of the receiver. When the light begins double-blinking red, the collar is turned on and capable of receiving signals from the transmitter. This process takes about 5 seconds.

Note that it takes about 20 seconds after turn-on before the collar can apply stimulation.



When the intensity dial is on zero, pressing any transmitter button turns the collar on or off. Move the dial to a number other than zero for training.

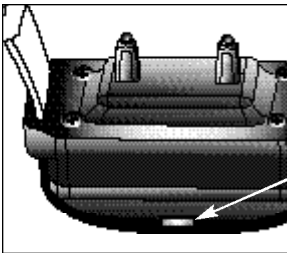

When the collar light blinks red, the collar is turned on.

Turning the Remote Trainer On and Off

To turn the collar off, repeat the turn-on process. The collar light will make one long red flash to indicate that the collar is now turned off. To save battery life between training sessions, you should turn the collar off.

After turning on the collar, it is a good idea to move the intensity dial to a number other than 0 (zero) so you don't accidentally turn the collar off the first time you correct the dog. However, at times when your transmitter might be accidentally bumped against objects during use, you can leave the intensity dial turned to 0 (zero) to prevent any possibility of an unwanted stimulation.

You can also turn a collar off by placing it on its charger. This feature allows you to turn a collar off if you cannot find its transmitter or the transmitter batteries have run down.

Turning the Remote Trainer On

- (1) Set transmitter intensity dial on zero.
- (2) Hold transmitter close to collar (up to 10 feet apart)
- (3) Hold any transmitter button down for about 5 seconds.
- (4) Watch for collar light to begin blinking.
- (5) Turn the intensity dial to a number other than zero.

Turning the Remote Trainer Off

- (1) Repeat the turn-on process.
- (2) Collar light will make one long flash to signal "off."

FITTING THE COLLAR ON THE DOG

Place the collar strap in the middle of the dog's neck. The receiver should be on the underside of his neck. Place the receiver so the light is facing forward (towards the dog's nose).

Tighten the buckle by holding it with two fingers as you pull the strap snug. Do not put any fingers under the strap as you tighten it. Always slip the free end of the collar strap through the D-ring.

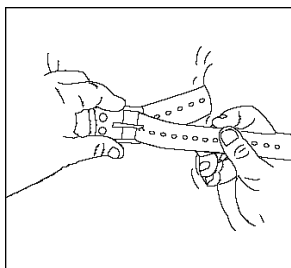

To tighten the collar on the dog, hold the buckle as shown and draw the strap snug. Remote Trainers need to be snug for consistent stimulation.



You can easily adjust the strap for different sized necks by sliding the receiver along the strap. If the collar strap is too long for your dog, you can cut off excess strap length. Leave enough length to go through the D-ring with about 3 inches to spare. Note: Do not cut the collar strap of the Sport 65 BPR until after you have also installed the Beeper on the strap.

Please note that Remote Trainers are not designed to be worn continuously by a dog. To prevent irritation caused by rubbing, remove the collar for at least eight hours out of every 24 hour period. See the important message about avoiding skin irritation on page 23.

SETTING THE INTENSITY

Your Remote Trainer can give corrections at different intensity levels, so you can match the level of correction to both the training situation and your dog's temperament. To adjust intensity level before or during training, use the intensity dial on the top of the transmitter.

The transmitter intensity dial gives you a choice of 6 intensities, in addition to the 0 (zero) setting for turning the collar on and off.

Intensity Dial Levels

- Level 0: Transmitter is off – no stimulation
Pressing a button turns the collar on or off.
- Level 1/2: Especially low intensity for extremely sensitive dogs
- Level 1: Very low intensity
- Level 2: Low intensity
- Level 3: Medium intensity
- Level 4: Medium-high intensity
- Level 5: High intensity

When increasing or decreasing intensity using the intensity dial, be sure you have released the stimulation buttons, or your new intensity selection will not take effect. Also note that moving the intensity dial while a stimulation button is held down will stop the stimulation. This is a safety feature.

If you are not experienced at using Remote Trainers, there are intensity selection tips in the training booklet and video that came with your Remote Trainer.

Using the Stimulation Buttons

USING THE STIMULATION BUTTONS

The Sport 50, Sport 60, and Sport 65 BPR offer two types of stimulation, “continuous” and “momentary.” The black button applies momentary stimulation. The red button applies continuous stimulation.

On the Sport 60, the small green button applies the audible tone.

Multi•Sport 2 and Multi•Sport 3 models offer continuous stimulation, only. Pressing the colored transmitter button – green, orange, or yellow – will cause the collar with the matching colored strap to apply continuous stimulation. (Be sure you have installed the correct color strap on each receiver, as described on page 7.)

Note that for a button to apply stimulation or cause an audible tone, the intensity dial must be on a number other than 0 (zero). If the intensity dial is on 0 (zero), pressing any button turns the collar on and off, as described on page 9.

Please see the section, “Model Guide” (pages 2 through 5), for the features of your model.

Using the Stimulation Buttons

Continuous Stimulation

The trainer controls timing of continuous stimulation. Continuous stimulation stays on while the transmitter button is pressed, up to a “time out” of about nine seconds. (If the collar times out, release the button briefly to restore collar function. Time-out is a very rare occurrence, and most corrections will be far shorter than the time-out period.)

Momentary Stimulation

The timing of momentary stimulation is pre-set. Momentary stimulation stays on only very briefly, no matter how long the button is pressed. To produce a second momentary correction, press the button again. To produce a series of momentary corrections, press the button for each correction.

Multi-Dog Models

The Multi•Sport 2 allows you to control two dogs at a time. The Multi•Sport 3 allows you to control three dogs at a time. Each color-coded transmitter button – green, orange, or yellow – corrects the dog who is wearing that color strap.

The intensity level when you correct each dog will be the one indicated by the intensity dial. Therefore, when training more than one dog using a Multi•Sport 2 or Multi•Sport 3 transmitter, you should check the intensity dial before correcting a different dog. By doing this, you can be sure that the intensity is what you want for that dog's correction.

USING THE TONE (Sport 60 only)

The Sport 60 collar makes an audible tone when you press the small green button. *

The meaning of the tone is determined by your dog's training. It can mean a particular command, a warning, praise, etc. The training materials that come with your Remote Trainer describe the use of this feature in more detail.

USING THE BEEPER (Sport 65 BPR only)

Pressing the small orange button on the Sport 65 BPR transmitter turns the Beeper on or off at a distance, up to the 1/2 mile range of the unit. Note that for the transmitter to control the Beeper, the Beeper must be turned on. For complete information about using the Beeper that comes with the Sport 65 BPR, see the separate Beeper manual included with that model. *

*The intensity dial must be set on a number other than 0 (zero) for the small button to operate the tone or Beeper. If the intensity dial is set on 0 (zero), pressing the small button turns the collar on or off (page 9).

RANGE

Your Remote Trainer has a range of one-half mile. Terrain, weather, vegetation, transmission from other radio devices in the area, and other factors affect the range.

RADIO SIGNAL ISSUES

Modern microprocessor technology virtually eliminates the possibility that your collar could be unintentionally set off by someone else with a Tri-Tronics product. Please call our Customer Service Department at **1-800-456-4343** with any questions.

FCC COMPLIANCE

The manufacturing of Tri-Tronics Remote Trainers involves exacting production methods, precise tuning, and stringent quality control tests. In addition, these products are designed and manufactured to operate within Federal Communication Commission (FCC) specifications. It is a violation of FCC rules to modify your equipment.

Tri-Tronics certifies its products to operate under Part 95 of FCC regulations. Unauthorized modifications to your equipment could result in its not meeting specifications and thus violating FCC regulations. Adjustments should only be performed by technically qualified personnel authorized by Tri-Tronics. To continue to meet FCC operating specifications, any replacement of circuit components (including antennas) must meet Tri-Tronics manufacturing specifications. The transmitter should only be operated with the Tri-Tronics antenna installed.

BATTERY CARE

The Sport Series Remote Trainer has rechargeable Nickel Metal Hydride (NiMH) batteries in the collar, and one replaceable 9-volt battery in the transmitter. The collar battery should be recharged periodically, as described below. The transmitter battery will last for many months, or even years, depending on usage.

Transmitter Battery

Your Sport Series Remote Trainer is shipped with one 9-volt battery installed. This battery will last for many months in normal usage. If you see the transmitter light flash rapidly when a button is pressed, it is time to replace the transmitter battery.

To change the battery, unscrew the small Phillips head screw on the back of the transmitter, and lift the battery cover off. Remove the old battery and install the new battery in the correct direction. Use a Duracell or Eveready 9-volt alkaline battery. Note that some other brands will be too long and will not fit correctly. Never force a battery into this compartment.

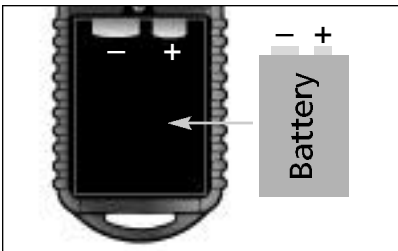

The larger battery terminal should touch the larger transmitter contact.

Replace the battery cover, tighten the Phillips head screw (do not over-tighten), and check for transmitter function by pressing a button while you watch the transmitter light. If the light does not illuminate, you may have installed the battery backwards. If so, take it out and turn it around.

Collar Batteries

Initial Charge. Charge the collar for about 14 hours before first using the unit.

When to Recharge. When the light on the collar blinks rapidly, you need to recharge the collar soon. The amount of time that collar batteries have left after the low battery indicator comes on depends on how you use your Remote Trainer during training, the temperature (less time remains during cold weather), and other factors. Normally you will be able to complete your training session after you see the low battery indicator.

How to Charge. Make sure there is no moisture in the collar charging jack when you attach the charger because moisture can interfere with proper charging. Charge batteries at room temperature. Do not charge at temperatures below freezing. Remember that it takes several hours for cold batteries to come up to room temperature.

Lift the rubber protection flap from the collar charging jack. Plug the charger into the wall outlet, then insert the charging plug into the collar jack. The collar light will glow red to indicate that current is flowing. When you are finished charging, unplug the lead from the collar before disconnecting the charger from the wall.

Reinstall the rubber protection cap correctly to keep dirt, debris, and water out of your charging jack. Seat the flap down firmly so that it is level with the surface of the collar, as shown in the illustration below. Keeping the charging jack clean ensures that your charger makes good contact. If the collar charging jack becomes dirty, clean it as described in the section, “Care and Cleaning” (page 21).

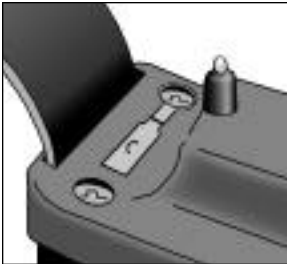

Protection cap
fitted properly



Protection cap not fitted
properly. Moisture and debris
can enter charging jack.

Use only the correct Tri-Tronics charger to charge your collar. Using the wrong type of charger may damage batteries or the collar itself. Do not charge batteries that are not installed in a collar.

Charging Time. Charge your collar for at least 14 hours. It's okay to use your collar before the 14 hours are up; it will function normally. A 14-hour charge ensures full battery capacity.

To get maximum life from your collar batteries, we recommend that you don't charge for more than 20 hours at a time. Occasionally exceeding the 20 hour limit will not harm the functioning of your batteries. However, this product is not intended to be left on a charger indefinitely.

Replacing Collar Batteries. Proper battery care will help ensure maximum life from your rechargeable collar batteries. When your collar batteries do need to be replaced, you can replace them yourself with parts obtained from Tri-Tronics. Follow the instructions that come with the replacement battery pack. Contact your local officials to find out whether any special disposal requirements applying to used NiMH batteries are in effect where you live.

While collar batteries are user-replaceable, they are not intended to be “field-replaceable.” Open a collar away from the field to avoid contamination. Open a collar only for the purpose of replacing batteries.

Storing a Remote Trainer

Before storing your Remote Trainer for an extended period, charge the collar for 14 hours. Thereafter, charge every two months while the collar is in storage, and charge for 14 hours immediately before first use. If the storage time will exceed six months, remove the 9-volt battery from the transmitter.

It's always best to store a Remote Trainer at room temperature.

CARE AND CLEANING

A little care can extend the life of your Remote Trainer and reduce service costs.

Charging Jack

Keep the protection flap secured over the battery charging jack. If the charging jack becomes dirty, flush thoroughly with clean tap water. If debris still remains, you can use the point of a toothpick to loosen remaining debris; be careful not to bend the contacts inside the jack. Important: Be sure to allow the charging jack to dry thoroughly after washing it before you connect a charger, or proper charging may not occur.

Antenna

Regularly check for tightness. If it becomes loose, hold it at the base and tighten firmly by hand.

Cleaning

Wash the collar with clean drinking water, especially after exposure to brackish, salt, or alkaline water. Use a small brush to remove any foreign materials around the screws and contact points.

Extending Battery Life

Caring for your batteries will prolong their useful life significantly. Don't leave the Remote Trainer in very warm areas such as the dashboard of your car when closed in the sun. Storing any type of batteries at high temperatures can significantly shorten battery life. Also avoid storing the batteries in extremely cold areas. Follow the battery charging instructions on page 17.

SERVICE AND WARRANTY

Customer Service

We hope that this manual has been helpful. If you have any questions, or you suspect your Remote Trainer is malfunctioning, please call our Customer Service Department at **1-800-456-4343**.

Before you call, please read the “Troubleshooting Guide” on page 25.

Factory Warranty

The Sport Series Remote Trainer is covered by a two-year warranty on parts and labor. The warranty is transferable to a new owner, but does not cover physical damage or abuse. The warranty is also void if the Remote Trainer has been altered or unauthorized service work has been attempted.

Repair Procedure

Always call our Customer Service Department before sending your Remote Trainer in for repairs.

If you send your Remote Trainer in for repair, either while under warranty or out of warranty, we may replace it with a reconditioned unit.

PRODUCT SAFETY

Important: Your dog should be able to wear the collar comfortably for several hours at a time. The collar is not designed, however, to be worn continuously. To prevent irritation caused by rubbing, remove the collar for at least eight hours out of every 24 hour period. Also, remote training collars are designed to be worn snug, and a collar that is worn too loose can contribute to skin irritation. Take a few moments each day to inspect the dog's neck for signs of redness or irritation caused by such rubbing. If signs of skin irritation appear, temporarily discontinue use of the Remote Trainer.

Scientific animal safety studies have been designed and conducted for Tri-Tronics by veterinarians and physiologists at a major university. The scientific investigations involved parameters of electrical stimulation that are similar to those in your Remote Trainer. The scientific studies tested for possible cardiopulmonary and epidermal effects of Tri-Tronics electrical stimulation applied to the ventral surface of the neck of healthy dogs. These studies found no clinically significant changes in electrocardiograms, blood pressures, or properties of the skin underlying the contact points.

Tri-Tronics Remote Trainers have two independent circuits that are designed to inhibit excessive electrical stimulation. One is located in the transmitter, the other is in the collar. Like all other parts of our products, these safety circuits receive special attention in Tri-Tronics environmental, reliability, and quality analysis.

Tri-Tronics Remote Trainers have the added safety feature of level 0 (zero) on the transmitter. At times when your transmitter might be accidentally bumped against objects during use, you can leave the intensity dial turned to 0 (zero) to prevent any possibility of an unwanted stimulation.

Please note: Even though Tri-Tronics products are safe, they are intended for use only in the training of healthy dogs. It is always wise before any type of training to have your dog checked by a veterinarian.

TROUBLESHOOTING GUIDE**PROBLEM #1: No stimulation – the collar light won't illuminate when a transmitter button is pressed.**

The collar has not been activated. The collar must be turned on or it won't work at all. Page 9 .

The transmitter intensity dial is set on zero. Select a position other than 0 (zero) Page 9.

An antenna is not installed in the transmitter, or is broken or loose. The antenna must be inserted in the transmitter for proper radio communication between it and the collar. Page 8. Check the antenna for physical damage and replace if needed.

The batteries in either the collar or the transmitter are dead. Recharge or replace, as needed. Page 17.

The collar batteries are not taking a charge. Either you need new batteries (page 19) or the battery charger is not working. See whether the collar light is glowing red while connected to the charger. The power may not be working. Try another wall outlet. If using a power strip, make sure it is switched on and working.

You are using the wrong transmitter. If you own more than one Sport Series transmitter, or train with someone who has a Sport Series unit, check that you have not accidentally switched transmitters.

PROBLEM #2: The Remote Trainer doesn't have range, or the range has been significantly reduced.

The antenna is not installed in the transmitter or is broken or loose. The antenna must be installed in the transmitter for proper radio communication between the transmitter and the collar. Page 8. Check the antenna for physical damage and replace if needed.

T R O U B L E S H O O T I N G C S Troubleshooting Guide

Either you or the dog is shielded by a metal structure.

Metal fences, chain link dog enclosures, screen doors, buildings, and other metal structures can affect the radio signal. Operate the Remote Trainer away from these structures.

The receiver is on backwards. Position the collar so that the light faces toward the dog's nose. Page 11.

You're experiencing temporary radio interference. Radio signals from nearby CBs and walkie talkies can reduce range. Wait a short while then try again, or move to another area.

PROBLEM #3: The stimulation seems too high, not high enough, or the dog does not seem to feel it at all.

The collar strap is not tight enough. The collar should be snug. Contact points must press against the dog's skin to provide efficient, consistent stimulation. Page 11.

The intensity position is not correct. The ideal intensity level depends on the dog and the training situation. Try a different level. See the training manual and video that came with your Remote Trainer. Also note that in very cold weather, you may need to use a slightly higher setting to achieve the same level of intensity. Remember that the stimulation button must be released for the new setting to take effect. Page 12.

The batteries in either the collar or the transmitter are dead. Recharge or replace as needed. Page 16.

Debris or contaminants are interfering with electrical stimulation. Clean the collar and contact point area. Page 21.

PROBLEM #4: The collar is difficult to turn on or turn off.

Begin the turn-on or turn-off cycle again. Occasionally you will need two tries to turn the collar on or off. For best results when turning the collar off, watch the collar light and begin pressing the transmitter button when the collar light is not flashing.

T R L T P O N I C S Troubleshooting Guide

The intensity dial is not set on 0 (zero). Select the 0 (zero) position for activating and deactivating the collar. Page 9.

The transmitter is too close to the collar. Hold it farther away, up to 10 feet. Page 9.

You are using the wrong transmitter. If you own more than one Sport Series transmitter, or train with someone who has a Sport Series unit, check that you have not accidentally switched transmitters.

An antenna is not installed in the transmitter, or is broken or loose. The antenna must be inserted in the transmitter for proper radio communication between it and the collar. Page 8. Check the antenna for physical damage and replace if needed.

You're experiencing temporary radio interference. Wait a short while then try again, or move to another area.

The batteries in either the collar or the transmitter are dead. Recharge or replace as needed. Page 17.

PROBLEM #5: The collar light indicates low charge very quickly.

The unit has been left on between training sessions. Make sure the collar is turned off after use. Page 9.

You are training in very cold weather. The low battery indicator comes on prematurely in very cold weather. Page 6.

Make sure the batteries are well charged. Page 17.

PROBLEM #6. The collar deactivates itself while training.

The intensity dial is set on zero. Select a position other than 0 (zero) while training or you can inadvertently turn the collar off when you try to correct the dog. Page 12.

The batteries have run down. The collar light may require 20 seconds to register "low batteries" after you turn the unit on. Check the collar after 20 seconds to see if the low battery indicator is on. You normally can complete a training session after the low battery indicator flashes, but not in very cold weather.

Make sure the batteries are well charged. Page 17.

PROBLEM #7. The collar light glows steadily even though the collar is not stimulating.

You're experiencing temporary radio interference. The light may illuminate when it receives any radio signal, even from other Tri-Tronics transmitters. This does not mean that stimulation is occurring.

PROBLEM #8. The collar light does not come on when the charger is plugged in.

The collar batteries are very low. The collar light will take a while to light during the charging cycle whenever the batteries are very low. This is normal and does not indicate a malfunction.

Debris in collar charging jack. Carefully clean the charging jack as described on page 21.

Faulty chargers. Call **1-800-456-4343** to order a replacement.

No AC current. Make sure the outlet you are using is operating.