

e-pill® DOSE-ALERT® Interval Timer

Instruction Manual

HOW YOUR DOSE-ALERT® WORKS

The Dose-Alert® is a timer that helps you remember to take your medication on time. Once activated, your Dose-Alert will count upward from 0:00 until it reaches the alarm set point, which is preset for a 24-hour interval. When it reaches the alarm set point, the Dose-Alert will beep 20 times and the clock will flash.

When the Dose-Alert beeps, to reset, press the Start/Reset button once, and it will reset to 0:00 and begin counting upward again. If you do not press the Start/Reset button, after 20 beeps the Dose-Alert will continue to count upward until it reaches the next alarm set point, at which point it will beep 20 times again.

If you do not press the Start/Reset button and let the Dose-Alert continue to run, the clock will continue until it reaches 99:59 at which point the clock will freeze. **Please note that this will quickly drain the battery.**

To Activate

Hold the battery slot and pull the tab to activate the timer. 24:00 will display on the timer. Press the Start/Reset button ONCE. The clock will flash, then display 0:00. It will then begin counting upward to the alarm set point.

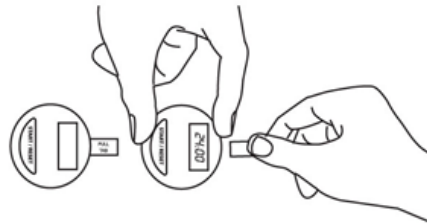

To Affix to your Prescription Vial Cap

Peel off the protective sheet covering the adhesive backing on the Dose-Alert exposing the adhesive. **FIRMLY** press the Dose-Alert to the top of your prescription vial cap.

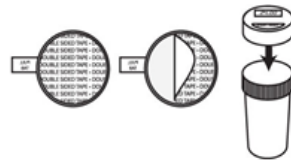

Important:

When removing the top of your prescription vial cap, grip the top of the prescription vial cap, **NOT** the Dose-Alert.

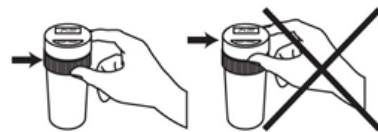

When you refill your prescription, transfer the entire top of the old vial cap with the Dose-Alert still affixed. Do not remove the Dose-Alert from the old cap.

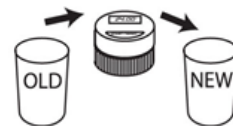

To Check the Alarm Interval

Press the Start/Reset button ONCE to check the alarm interval. (Comes preset at 24 hours.)



To Change or Reset the Alarm Interval

Hold the Start/Reset button for 5 seconds. After 5 seconds, the number 24:00 will change to 1:00, then 2:00, etc, and increase by 1 hour for each second you hold the button. Release the button when your desired hourly interval is displayed. This setting will remain unless changed again.

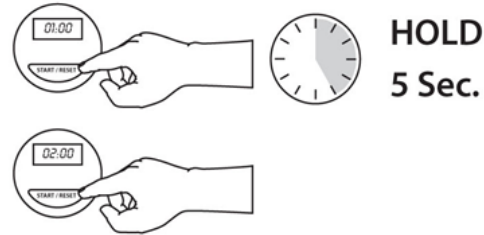

<u>Times/day you take medication</u>		<u>Set for</u>
1 x / day	=	24 hrs
2 x / day	=	12 hrs
3 x / day	=	8 hrs

Note: This is only to reset the Dose-Alert in between doses. For normal use, when the Dose-Alert beeps and you press the Start/Reset button it will automatically reset to 0:00.

To Replace the Battery

Pull out the battery tab and replace the battery with an LR1130 button cell or equivalent, making sure that the positive (+) side is facing away from the front of the unit.

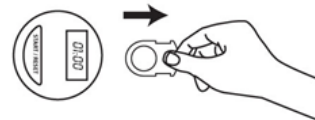

The Dose-Alert is intended to serve as a back-up reminder system to help remind you to take your medication. It is not intended to be the sole source for you to remember to take your medication. The Dose-Alert requires you to properly set and activate it. It is battery powered, and when the battery runs out it will cease to function.

Like any electronic device, it can cease to function for a variety of reasons, including but not limited to exposure to moisture or to excessive hot or cold temperatures. You agree that the limit of Dose-Alert's liability to you arising from any claim involving the use or malfunction of a Dose-Alert shall be the purchase price that you paid for the Dose-Alert.

By activating the Dose-Alert, you agree to these terms and conditions. If these terms and conditions are not agreeable to you, you may return the Dose-Alert and your original receipt to the company and receive a full refund of your purchase price.

e-pill[®] Medication Reminders
e-pill, LLC, 70 Walnut Street, Wellesley, MA 02481, USA
www.epill.com 1-800-549-0095