

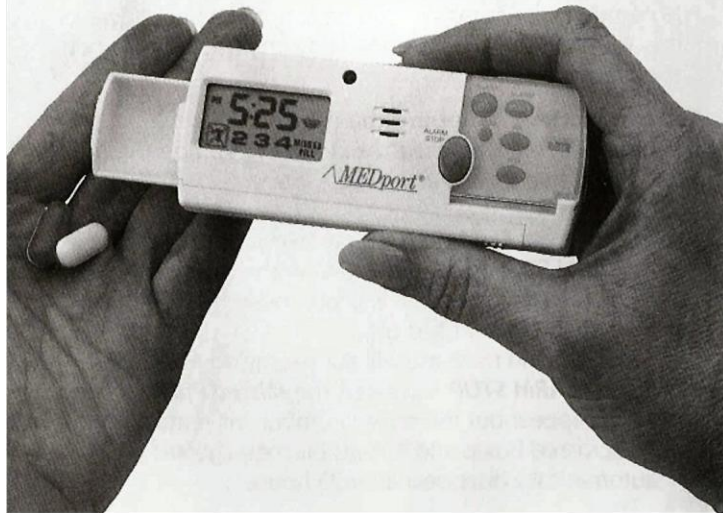

*There is no better system  
for remembering  
and taking daily meds.*



## **MEDglider** Talking Reminder® SYSTEM

*1 to 4 Times a Day  
Medication Timer*

How to attach  
your **MEDglider**  
timer to the pill box.

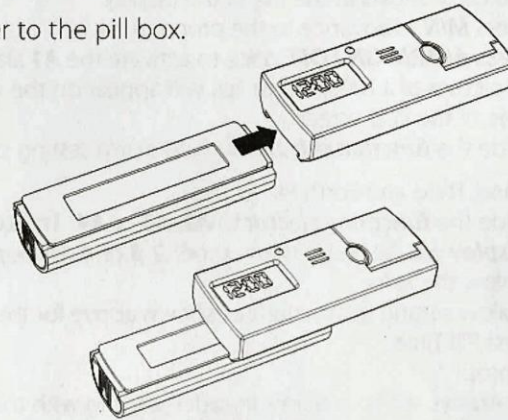

The **MEDglider** System is an innovative way to manage your daily medication use. The handy and attractive pill boxes fit easily into pocket or purse and provide space for up to four pill times each day. Using the **MEDglider** Storage Tray, you can pre-plan your entire weeks medication so it's ready and waiting each and every morning.

The **MEDglider Talking Reminder**® is a great way to know when to take your pills. The Reminder works alone or slips securely onto the Glider Pill Box and can be carried wherever you go. The alarm can be set up to four times a day. You can choose one of three alarm types including Beeper, Silent Flashing Light or even a gentle Voice mode to remind you that it's "Time to take your pill."

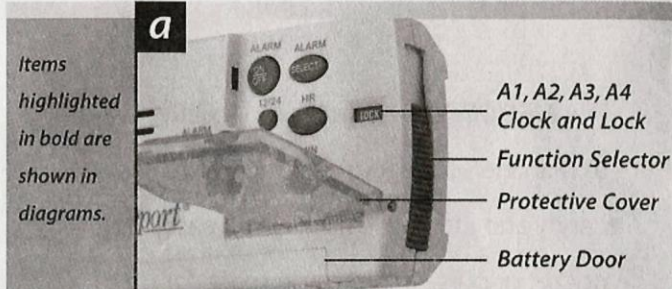

Items highlighted in bold are shown in diagrams.

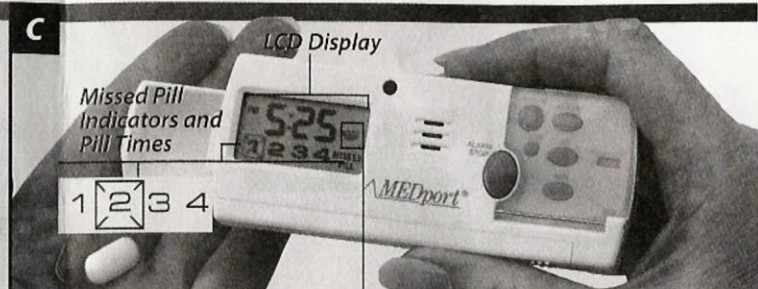
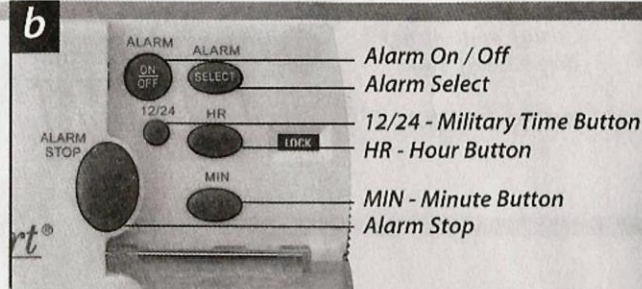

## INSTRUCTIONS

For Programming your **MEDglider Talking Reminder®**

To insert batteries, slide **battery door** off and insert two "AAA" size batteries making sure the negative (-) terminals point towards the springs. When inserting batteries insert the battery that is located under the **LCD display** first. Alarm will beep.

### Setting the Clock (refer to diagrams a & b)

Note: You may select military time by pressing the **12/24** button.

1. Open the **protective cover** to access the set buttons.
2. To set the clock to the current local time:
  - a. Slide the **function selector** to **CLOCK**. The **LCD display** will flash.
  - b. Press **HR** to advance the hour.  
Note: To set for PM, continue pressing until the PM indicator shows at the left of the display.
  - c. Press **MIN** to advance to the proper time.

### Setting the Alarm Times (refer to diagrams a, b, & c)

1. First Pill Time:
  - a. Slide the **function selector** to **A1**. The **LCD display** will flash and the number **1** will appear below the time.
  - b. Press **HR** to advance the hour.

- Note: To set for PM, continue pressing until the PM indicator shows at the left of the display.
- c. Press **MIN** to advance to the proper time.
  - d. Press **ALARM ON / OFF** once to activate the **A1** alarm. A picture of a bell, light or lips will appear on the right side of the LCD screen.
  - e. Slide the **function selector** to next alarm setting position.

### 2. Second, Third and Forth Pill Times:

- a. Slide the **function selector** to **A2, A3** or **A4**. The **LCD display** will flash and the number **2, 3** or **4** will appear below the time.
- b. Follow setting instructions as shown above for the First Pill Time.

Notes:

1. Always set your alarms in order starting with the first of the day. That is, morning will be number 1, mid-day number 2 and so on.
2. Always return function selector to **LOCK** when settings have been completed.

### Setting the Type of Alarm (refer to diagram d)

1. There are three Alarm Types to choose from:
  - a. **Beeping Alarm** - indicated as a Bell
  - b. **Voice Alarm** - "Time to take your pill" - indicated as Lips
  - c. **Visual Alarm** (Blinking Light) - indicated as a Light Bulb

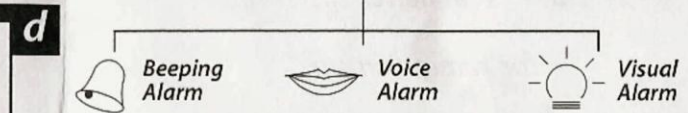

2. The alarm type can be changed at any time. To change, press **ALARM SELECT** until the picture of the Alarm Type desired is displayed in the **LCD display**.
3. Close the **protective cover**.  
Note: only one Alarm Type can be active at a time however the alarm type may be changed anytime other than when the alarm is ringing.

### Alarm Function / Stopping the Alarm

When the pill time is reached, the alarm will turn on. Each pill time will give 3 alerts at 1 minute intervals.

1. To Stop the Alarm:
  - a. Simply press **ALARM STOP** and take your medication.
  - b. If **ALARM STOP** is not pressed after the third reminder a box with a crossed line will form over the Pill Number to alert you to a missed pill.
  - c. Also, a second message will appear saying **Missed Pill**.
  - d. Once **ALARM STOP** is pressed, the **Missed Pill** message will disappear but the boxed number will remain.
  - e. The crossed boxes and missed pill message will automatically disappear after 23 hours.